

# PLANTAIN

An impressive family home, with a modern front elevation, the Plantain is a distinctive four-bedroom, three-storey property.

141 sq m (1,518 sq ft)

CHILMINGTON  
RISE  
KENT

ASHFORD KENT TN23 3DN

[www.chilmington-rise.co.uk](http://www.chilmington-rise.co.uk)

Connells

# PLANTAIN

An impressive family home, with a modern front elevation, the Plantain is a distinctive four-bedroom, three-storey property.

Allocation of garages, carports and off-road parking differs from plot to plot. For more information, please speak to the sales team.

**141 sq m (1,518 sq ft)**

Externally, the property features some striking features - such as the metal porch over the front door, the matching surround to the first and second floor windows and the pretty Juliet balconies to the windows on the front and rear of the house.

The master bedroom occupies the entire second floor with an en-suite featuring a bath and a shower.

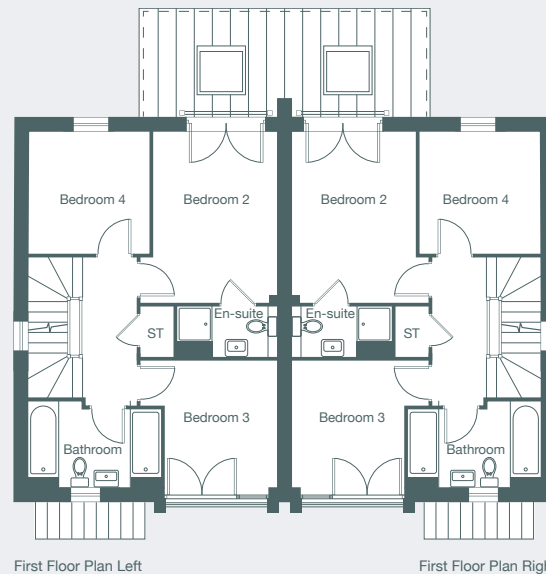
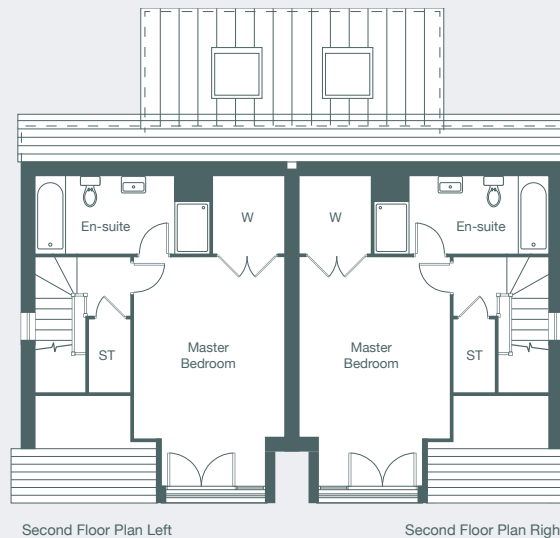
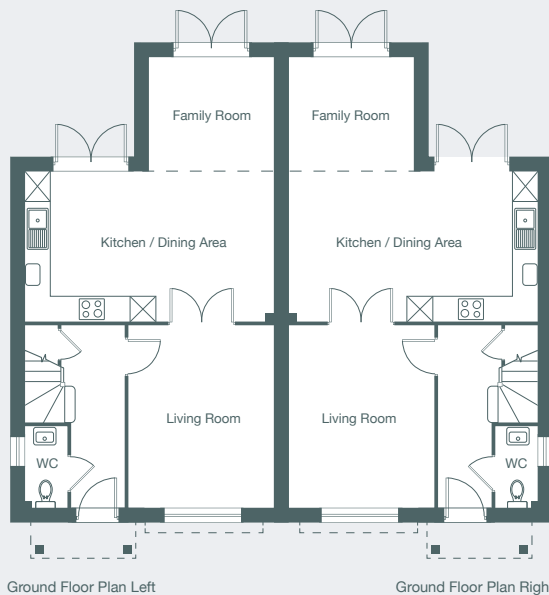

## GROUND FLOOR

### Kitchen / Dining Area

5.92m x 3.65m 19'5" x 12'0"

### Living Room

4.37m x 3.44m 14'4" x 11'3"

### Family Room

2.98m x 2.70m 9'9" x 8'10"

## FIRST FLOOR

### Bedroom 2 with en-suite

3.89m x 3.08m x 12'9" x 10'1"

### Bedroom 3

2.87m x 2.80m 9'5" x 9'2"

### Bedroom 4

2.76m x 2.74m 9'1" x 9'0"

## SECOND FLOOR

### Master Bedroom with en-suite

5.38m max x 3.56m x 17'8" max x 11'8"

Each set of floor plans may be reproduced at a different scale to others within the brochure. Floor plans, dimensions and CGI illustrations are indicative only and can be liable to change during construction. Please check with the sales agent if you require further information.



### Sales Suite

Open Daily

Monday to Sunday 10am-5pm

### Telephone

01233 622 206

01233 502 020

### PLANTAIN

Plots 48, 49, 82, 83, 84, 85.